

Next Step

ESTATE AGENTS



LAND Hart village, Hartlepool, TS27 3AJ

Offers in the region of £95,000

Next Step Property are thrilled to offer to the market this building plot / land with planning permission for a 2 bedroom dormer bungalow.

Description



Located in the popular village of Hart on the outskirts of Hartlepool, this building plot is in a desirable location and benefits from planning permission for a 2 bedroom dormer bungalow.

to see full details of the planning application and aproval, visit the HBC planning portal, REF: H/2018/0192

Aprox area size 484 sq meters.

Freehold

Floor Plan

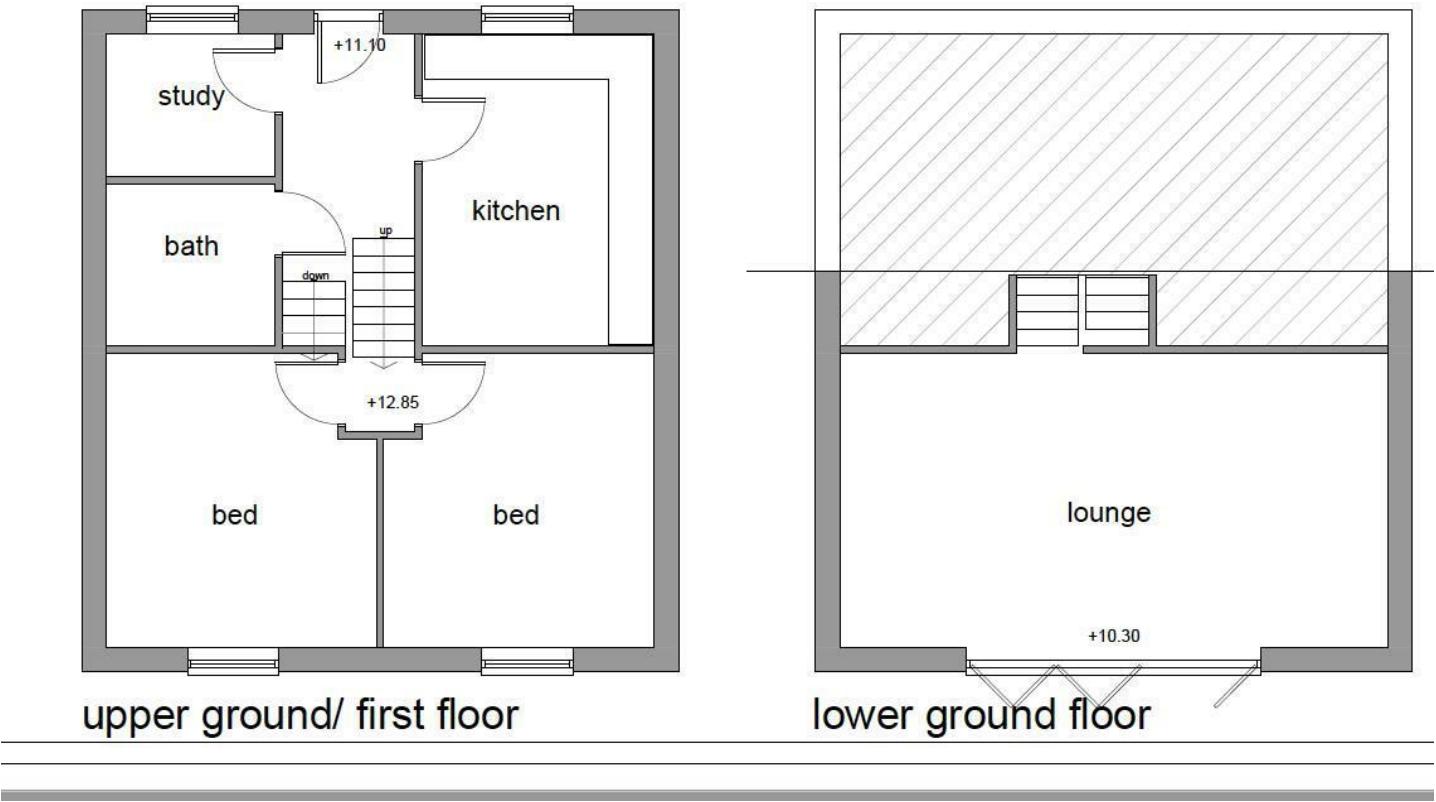

Area Map



These particulars, whilst believed to be accurate are set out as a general outline only for guidance and do not constitute any part of an offer or contract. Intending purchasers should not rely on them as statements of representation of fact, but must satisfy themselves by inspection or otherwise as to their accuracy. No person in this firm's employment has the authority to make or give any representation or warranty in respect of the property.

Energy Efficiency Graph

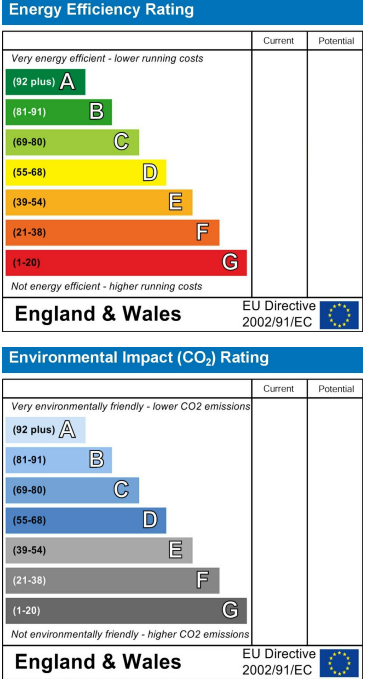

Registered Office:
Next Step Property Ltd
12 Victoria Road, Hartlepool, TS24 7SD
Registered in England & Wales 9957597

TEL:01429 597840
info@nextstepproperty.co.uk
www.nextstepproperty.co.uk